

The SGD Awards 2014

In a special 15-page section, we profile the winners of the SGD Awards, the only UK Awards dedicated to professional excellence in garden design

IN ASSOCIATION WITH



KEY DATES FOR SGD AWARDS 2015: Plans are already afoot for this year's Awards, so make a note of these dates in your diary now! **24 April** – Early bird deadline for Main awards (entry forms and fees) **29 May** – Final deadline for Main awards (entry forms and fees) **21 June** – Deadline for entries (Main entries) **24 July** – Early bird deadline for Student & Community Awards (entry forms and fees) **14 August** – Final deadline for Student & Community Awards (entry forms and fees) **7 September** – Deadline for entries (Student and Community entries)

The Judges



Trudi Entwistle

Trudi lectures in Landscape Architecture at Leeds Metropolitan University and is also a site-specific artist. Her artwork lies between land art, sculpture and design and has been shown throughout the UK as well as internationally. Through teaching, research and art, Trudi is interested in how sculptural forms integrate with their surroundings and interact with human movement. Trudi judged the main awards.



Richard Sneesby

Richard is a landscape architect, garden designer, author and former course leader of the award-winning degree course in Garden Design at University College Falmouth. He has presented a number of TV series, was co-author of *The Garden Maker's Manual* and wrote a section of the *RHS Encyclopedia of Garden Design*. His design practice has won a number of design awards. Richard judged the main awards.



Bill Burford

Bill is a lecturer, landscape architect and garden designer with a passion for innovative concepts, well-planned spaces and biodiversity. He has designed and constructed a variety of public and private gardens, therapeutic landscapes and wetland habitats worldwide. He currently leads a degree course in Landscape Architecture at the University of Gloucestershire. He judged the main awards.



Arabella St John Parker

Arabella is Houses & Gardens Editor for *Homes & Gardens* magazine and has enjoyed gardening since childhood, when her father set aside patches of garden for her and her siblings to cultivate. Today she enjoys visiting other people's gardens and, as a gardening editor, working with and learning from real experts in the gardening world. Arabella judged both the main awards and the Student Award.



Sarah Eberle

Sarah is a landscape architect and garden designer with 30 years' experience; she is known as a 'fusion style' designer, producing work of an eclectic mix. Sarah is also a regular designer on the RHS garden shows circuit and has nine RHS Gold medals, including Best in Show Chelsea 2007. Sarah works from her home in Hampshire. Sarah judged the Student Designer Award.



Julie Toll

Julie Toll has been designing gardens in the UK and abroad since 1982, gaining international recognition by winning seven gold and two silver medals including Best in Show at the Chelsea Flower Show. She trained at Pershore College of Horticulture, specialising in trees and shrubs before studying to become a garden designer at the English Gardening School. She is a fellow of the Society of Garden Designers.



Deborah Trentham

Deborah is a garden historian who has an in-depth background in the history of art, design and architecture. She has been lecturing in garden history for 15 years and currently teaches on KLC's Garden Design course at Hampton Court Palace as well as running her own courses in Garden History at Burgh House, Hampstead. She is currently obsessed with Italian Renaissance Gardens.



Paul Nulty

Paul is an award-winning lighting designer. Combining creativity with an eye for detail, his theatrical lighting background provides a unique understanding of the relationship between space and light. He sees illumination of the external environment as an important opportunity to create theatre through contrast, drama and composition. He set up Paul Nulty Lighting Design in 2011. Paul judged the Lighting Award.



The Awards Ceremony

ON FRIDAY 30 JANUARY 2015, the SGD 2014 Awards Ceremony, sponsored by Europlants, took place at Millennium Gloucester Hotel in London. The hotel's roof-top conservatory was the setting for a Champagne reception before guests sat down to dinner. Following welcome speeches by SGD Chair Philippa O'Brien MSGD and Paul Hayden from Europlants, Matthew Wilson hosted the SGD Awards presentation.



IN THE PICTURES:

- (1) The finalists
- (2) John Brookes MBE FSGD and Julia Boulton, the granddaughter of Beth Chatto, winner of the John Brookes Lifetime Achievement Award
- (3) The SGD awards ceremony
- (4) Cleve West MSGD (right) and Mark Straver from Hortus Loci
- (5) Matthew Wilson, Helen Basson and Alex Denman of the RHS
- (6) Anne-Marie Powell (left) and Petra Hoyer-Miller
- (7) Dan Pearson MSGD
- (8) Philippa O'Brien MSGD, SGD Chair
- (9) The Champagne reception



SPONSOR: Landform
WINNER: Debbie Roberts MSGD

INTERNATIONAL AWARD

Awarded to a garden or landscape project outside of the UK. Open to FSGD and MSGD

PROJECT: *Le Haut*
LOCATION: *Guernsey*

About the garden:

The garden surrounds a refurbished and extended traditional granite house set among a network of high-banked lanes, and is second home for an English family with young children. It has good views and steep olive terraces.

The designer's role:

The new design keeps the garden inward looking to provide shelter but with glimpses out at key points to link with the surrounding landscape. Level changes have been exploited across the site and sheltered terraces and seating spaces are linked by weathered stone paths through carefully detailed granite retaining walls and planted banks that nestle the house and garden into the landscape. The planting scheme complements the surrounding countryside but has a contemporary edge with architectural lines nearer the house.

The judges said:

- "An amazing garden with intense displays of colour and form."
- "Vistas are resolved and connected."
- "A very natural design, specific to the site that establishes a calm, beautiful and textural atmosphere."

RIGHT: The refurbished granite house at the heart of Debbie's award-winning garden
FAR RIGHT: Sheltered terraces and seating spaces are linked by weathered paths



ABOVE: Seating is sheltered by planted banks and granite retaining walls
LEFT: Mark Gregory of Landform and Debbie Roberts MSGD, winner of the International Award

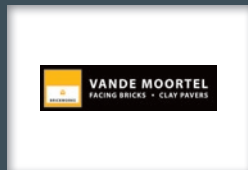

SPONSOR: Vande Moortel
JOINT WINNERS: Guy's & St Thomas' Courtyard Garden;
 Tufnell Park School Infants' Playground

DESIGNING FOR COMMUNITY SPACES AWARD

Awarded to a design for a communally used public, semi-public or communal outdoor space of any size within the UK. Open to members and non-members

GUY'S & ST THOMAS' COURTYARD GARDEN
 (Annie Chapman Pre-registered Member) Location: London

About the garden:

A courtyard measuring 700 sqm in space shared by the teaching campus of Guy's Hospital and Kings College. The garden was commissioned by Guy's & St Thomas' Charity for the community that live and work there as a much needed green space to act as a counterpoint to the busy surrounding streets.

The designer's role:

The primary challenge was to open up the existing walled garden to create a welcoming environment. Bold lines were used to spiral around the courtyard, with robust planting to thrive in limited light forming the green structure and sheltering wildlife. Trees will provide additional screening from buildings as they mature. The design aims to offer a new public space with seating for individuals and small groups, making good use of any available sunlight.

The judges said:

- "A clever piece of design that achieves a complete transformation of the site."
- "Great attention to proportions and scale supported with great detailing."
- "A calming space that adds beauty to the building façade."



Photo: Simon Kennedy



LEFT: Jackie Herald Pre-registered Member and Annie Chapman Pre-registered Member, joint winners of the Designing for Community Space Award, with Gert Gillis of Vande Moortel Brickworks **BELOW:** Tufnell Park School Infants' Playground **BOTTOM LEFT:** Guy's and St Thomas' Hospital Courtyard Garden



TUFNELL PARK SCHOOL INFANTS' PLAYGROUND
 (Jackie Herald Pre-registered Member) Location: London

About the garden:

Jackie was asked to design a garden provided by funds raised by the HSA (Home School Association). The parents provided a design brief that included seating under the existing large beech tree, soft play areas and multi-sensory planting including herbs. They wanted a combination of quiet solitary space, social space and room for the children to run about.

The designer's role:

Jackie involved the children and their ideas were based on walks through local parks. Top of the children's list were: a maze, a curly path, a jungle and a bench on which the whole class could sit together. The new garden uses bamboos as a maze, markings on the tarmac to prompt informal games, plus areas for natural play using bark, herbs, tough grasses and boulders to touch, sit or climb on.

The judges said:

- "Very thoughtfully designed with the curriculum in mind."
- "A great design that shows real community spirit."
- "Inspiring use of a challenging budget."





SPONSOR: British Sugar TOPSOIL

JOINT WINNERS: Joanna Midwinter Student

Member; Jiyoung Kim Student Member

STUDENT DESIGNER AWARD

Awarded to a design completed by a student member. Schemes in this category do not have to be constructed. Open to Student members and qualifying Pre-registered members only



JOANNA MIDWINTER'S PROJECT: *The New Great Square*

About Joanna Midwinter's garden:

Joanna chose to re-develop the unloved Geoffrey Jellicoe post-war urban landscape of New Great Square in Plymouth.

The designer's role:

The new design redevelops the area as a garden and social venue. It has been re-imagined as a vibrant 21st-century space that creates opportunities for contemporary tastes and activities. A new urban garden responds to the monumental civic architecture of the 1960s, but is contrasting in terms of light, colour, human scale and complexity. There is a focus on the use of local building materials and the new perennial planting is referenced from examples as far away as West Cork in Ireland and Missouri, USA.

The judges said:

- "Practical, beautiful, a real ring of truth about it."
- "Very sensitively executed in consideration of the existing site."
- "Very practical for the public."
- "A mature approach to dealing with an iconic design while creating something for 21st century use."



JIYOUNG KIM'S PROJECT: *Deep Simplicity*

About Jiyoung Kim's garden:

The design is for a dockland site in Rotherhithe, which has limited human access and is in need of natural restoration.

The designer's role:

The far-reaching plan involves water and forest walks, a prairie garden, oak maze and pedestrian plaza as well as innovative ideas for the old gas towers. The title 'Deep Simplicity' represents the notion that underlying all of life's chaos is a simple order based on Heidegger's philosophy that humans should be aware of life and death – humans can regain the simple truth of the life through deep thought and contemplation, even though we may lose our direction in life.

The judges said:

- "Incredibly impressive design."
- "Ingenious use of existing site."
- "A dynamic design, creatively integrating with the existing site."
- "A phenomenally challenging concept."
- "A mature approach to dealing with the sheer scale of the site."



ABOVE: Jiyoung Kim's philosophical 'Deep Simplicity' design

LEFT: Jiyoung Kim Student Member (left) and Joanna Midwinter Student Member, joint winners of the SGD Student Designer Award



SPONSOR: CED Natural Stone
WINNER: Cleve West MSGD

PUBLIC OR COMMERCIAL OUTDOOR SPACE AWARD

Awarded to a communally used public, semi-public or commercial outdoor space, of any size within the UK. Open to FSGD and MSGD

PROJECT: *Horatio's Garden*
LOCATION: *Salisbury*

About the garden:
17-year-old Horatio Chapple, who was killed by a polar bear, was a volunteer at the Duke of Cornwall Spinal Treatment Centre in Salisbury. The site of the new garden is protected to a degree from prevailing southwest winds but exposed to weather from the northeast. It occupies a mostly level space to the north of the spinal unit, originally a playground of grass and tarmac paths. The architecture is dominant and an assortment of semi-mature park trees offered shade and screening but lacked harmony and restricted scope for wheelchair-friendly access.

The designer's role:
The design draws on Horatio's own research and takes into account the views of patients, nurses, therapists, doctors and managers. It incorporates the form of a spine in low limestone walls that double as seating. Paths and gathering spaces are wide enough for beds and wheelchairs, and plants have been chosen for their aesthetic and multi-sensory qualities.

The judges said:

- "A garden full of life and hope."
- "Good spatial flow and simple planting that worked with the scale of the building."



ABOVE LEFT: Horatio's Garden
ABOVE RIGHT: Cleve West MSGD, winner of the Public or Commercial Outdoor Space Award, with Giles Heap of CED



ABOVE: Four different levels in the garden make the most of the view across the water
RIGHT: Rosemary Coldstream MSGD, winner of the Pocket Garden Awards, with Murielle Jayer of Platipus Anchors



SPONSOR: Platipus Anchors
WINNER: Rosemary Coldstream MSGD

POCKET GARDEN AWARD

Awarded to a domestic project of less than 100m², including courtyards, roof terraces and front gardens, within the UK

PROJECT: *The River Garden*
LOCATION: *Hertfordshire*

About the garden:
This is a modern courtyard garden in a dramatic setting. The brief was to make the most of the location next to a small river.

The designer's role:
Four gradual changes of level help enhance views across the water, and the geometric design – with an emphasis on the horizontal – maximises the width of the garden and helps frame the view. A lower terrace, reminiscent of a jetty, is cantilevered over the water and wraps around a tree. The curved seating is a lovely late-afternoon spot to sit and watch the local wildlife drift by.

The judges said:

- "A thoughtfully designed space offering an individual solution to an unusual location."
- "Interesting ideas, seamlessly executed."
- "Very pleasing lines."



SPONSOR: Stonemarket Ltd
WINNER: Sue Townsend MSGD

SMALL RESIDENTIAL GARDEN AWARD

Awarded to a domestic project of more than 100m² and less than 400m² within the UK. Open to FSGD and MSGD

PROJECT: *Contemporary Curved Courtyard*
LOCATION: *Suffolk*

About the garden:
The house has been recently constructed and the site had been cleared of all topsoil except under existing privet and silver birch trees, the roots of which had been exposed. The garden is adjacent to a school playground and buildings so needed screening to the south and east, and there was an awkwardly shaped area to the south of the property under a large sycamore.

The designer's role:
The new garden needed to echo the curved façade of the property and provide the clients with a smooth transition from indoors to outside, an outdoor kitchen, dining area and lower lounge area, an upper terrace for sunbathing, a water feature and structural planting with a hint of Australasia. Soil levels needed to be raised with a retaining wall.

The judges said:

- "A challenging L-shaped space, the design unifies three distinct functional spaces, which merge effortlessly through level change and the use of lively textural planting."
- "It has made use of all aspects of small-scale garden living, from the connection and extension with the indoor living space to the detail and delight of close association with planting."



LEFT: Sue's design complements the building's curved façade
BELOW: Sue Townsend MSGD, winner of the Small Residential Garden, with David Morris of Stonemarket Ltd



Photo: Marianne Majerus

LEFT: Charlotte's classically contemporary design
BELOW: Charlotte Rowe MSGD, winner of the Medium Residential Award, with Simon Burvill of Gaze Burvill Ltd



SPONSOR: Gaze Burvill Ltd
WINNER: Charlotte Rowe MSGD

MEDIUM RESIDENTIAL GARDEN AWARD

Awarded to a domestic project of more than 400m² and less than 3,000m² within the UK. Open to FSGD and MSGD

PROJECT: *Wimbledon Garden*
LOCATION: *London*

About the garden:
A 650m² established garden with many mature trees, some of which were in poor condition, with a large raised York stone terrace and lawn.

The designer's role:
The client wanted a stylish, formal and classically contemporary design. A new upper terrace has been created with two staircases and English limestone paving. A water rill cuts through cloud planting of clipped *Buxus sempervirens* and water falls over the edge of a 1.2m wall of polished granite and this is mirrored at the end of the garden by a polished granite strip and monolith. Below the terrace is a fireplace garden with an arbour in Western Red Cedar and a log fire as its main focal point. Next to this is a petanques court planted with tall, multi-stemmed amelanchier and edged with a row of box-pleached *Carpinus betulus*. There is a limited planting palette of greens and creams, interplanted with perennials and ground cover, as well as newly-planted trees.

The judges said:

- "Good proportions, beautiful site lines and amazing finish."
- "A harmonious design that worked perfectly with the house."
- "Crisp design detailing, slickly executed and enduring well."
- "Felt like a sublime haven."



SPONSOR: Sculpture By The Lakes
WINNER: Ian Smith MSGD

LARGE RESIDENTIAL GARDEN AWARD

Awarded to a domestic project over 3,000m² within the UK

PROJECT: *Millwater*
LOCATION: *Surrey*

About the garden:

This country garden surrounds a refurbished and extended house designed in the Surrey vernacular style. Close to the River Wey, it has a mill race running through it and an existing lake.

The designer's role:

The new garden embraces water in many guises, with formal ponds and fountains complementing the natural flow of water through the site. Linked spaces progress from an intimate family garden with terraces, lawn and swimming pool via vistas and formal axes to a more expansive landscape with a pleached tree avenue, walled kitchen garden, lawns, meadows and architectural follies – culminating in the refurbished lake with a new boathouse and jetties.

The judges said:

- “A transformational project.”
- “Designed as a journey through spaces that felt composed and perfectly linked. Had the feel of a period garden.”
- “Confidence of scale.”
- “A slickly executed integrated design with sharp edges softened with sophisticated planting.”



ABOVE: The pleached tree avenue
RIGHT: Ian Smith MSGD, winner of the Large Residential Award, with Monique Gudgeon of Sculpture by the Lakes



RIGHT: Water features prominently in Ian's winning design



SPONSOR: Stockscape
WINNER: Charlotte Rowe MSGD

HARD LANDSCAPE AWARD

Awarded to a project demonstrating the consideration given to the hard landscaped element of a domestic, commercial or public space in design and construction. Open to FSGD and MSGD

PROJECT: *Wimbledon Garden*
LOCATION: *London*

About the garden:

Winner of the Medium Residential Garden Award (see page 21)

The judges said:

- “Attention to detail is so important in this type of garden, where the concept and composition are about contemporary luxury.”
- “Hats off to the designer, contractor and client, who have all understood the critical role of hard landscape in this sort of project.”



RIGHT: Charlotte Rowe MSGD, winner of the Hard Landscape Award, with Lucy Bravington of Stockscape **BELOW:** One aspect of Charlotte's winning design



ABOVE: A scented garden to evoke childhood memories featured in Rebecca's design
RIGHT: Rebecca Smith, winner of the Small Budget Award, with Craig Ormiston of Lapa Company



SPONSOR: Firemagic
WINNER: Rebecca Smith
Pre-registered Member



SMALL BUDGET GARDEN AWARD

Awarded to a project within the UK where the total budget (not including designer fees) does not exceed £20,000. Open to FSGD, MSGD and Pre-registered members

PROJECT: *The Old Bakery*
LOCATION: *Hampshire*

About the garden:

The space is overlooked by a kitchen, playroom and snug, and is used as a cut-through to an office.

The designer's role:

To serve as a reminder of a childhood spent in Kenya and the south of France, the client wanted a traditional, scented, flowering garden; repeat-flowering roses are now a highlight. Year-round interest and evergreen structure have been introduced, a lawn removed, levels reconciled and there are now two seating areas for morning and evening use.

The judges said:

- “A designer's most common commission is to create a low-maintenance space with a low budget. This is an excellent example of how to work with both, and how to transform an under-used area into the garden the house deserves.”



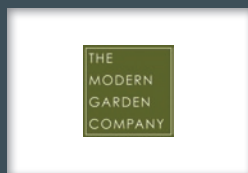

SPONSOR: The Modern Garden Company

WINNER: Gavin McWilliam Pre-registered Member and Andrew Wilson FSGD

PAPER LANDSCAPES AWARD

Awarded for a design idea that has yet to find a client or an opportunity for expression. Open to FSGD, MSGD and Pre-registered members

PROJECT: *Snow Hill*

LOCATION: *Birmingham*

About the garden:

A recent development adjacent to a railway station in Birmingham has created an open space between two major office buildings on the rooftop of an underground car park. It was originally intended as the site of a 5-star hotel but this was never built, except for two massive foundations creating a kind of gateway to the space.

The designer's role:

The brief was to stimulate use of the space with the potential for further development. Existing steps are retained and paved using basalt to match the main route through the plaza. There is dense woodland planting at raised level, inaccessible to users of the space but creating bold planting masses to soften the main plaza and having impact when viewed from the new development and adjacent urban spaces. Cladding to the retaining walls is to be textured steel with ribbed supports. A central walkway cuts across the main plaza, slightly raised above slab level to create the effect of an elegant, low bridge. This provides a step down into the main paved areas but also allows lighting to flood across the space from the recessed space below the paving. A man-made forest of carbon fibre masts creates an experience of urban woodland character. Each mast is topped with an LED lighting fixture, suggesting light from the buried glass factory below. Several seating spaces are proposed. The paved surface of the plaza runs across the tramway to link the tracks into the overall scheme.

The judges said:

- "A beautifully conceived, conceptual design that will energise a temporary landscape."
- "This type of project is increasingly important with the transient nature of urban spaces."



ABOVE: Gavin McWilliam Pre-registered Member and Andrew Wilson FSGD, winners of the Paper Landscape Award, with Lynne Isham of The Modern Garden Company

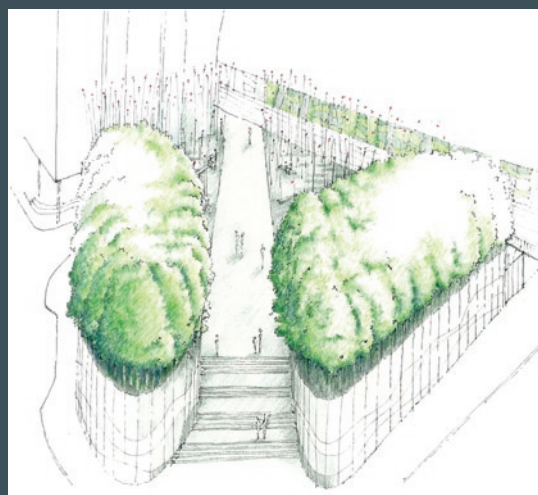

ABOVE AND LEFT: Judges praised the design's energising qualities. Forest perspective across main pathway (left); View from steps (far left); Bird's-eye view of the forest concept (bottom)

THE SGD 2014 AWARDS



SPONSOR: Deepdale Trees Ltd

WINNER: John Davies Pre-Registered Member

FUTURE DESIGNER AWARD

Awarded to a domestic or commercial project within the UK. Open to Pre-registered members who have been practising for less than five years

PROJECT: College Crescent

LOCATION: London

About the garden:

The design is for the gardens of six houses in a new development, with a central courtyard area, balcony planters and roof terraces.

The designer's role:

The design for the lower garden of each house is conceived as a snapshot of a larger space and each garden is a natural extension of the internal living area. Bespoke water features offer a unifying design element as well as individuality for each area, and planting includes strong evergreen structure overlaid with predominantly woodland edge herbaceous planting. Lighting gives the garden spaces a theatrical feel.

The judges said:

- "Individually, these gardens would be worthy winners, but to have six of such high quality is unusual and hugely gratifying."
- "There is a lot to be learned from this approach. It's a great example of how gardens can add value to properties."



TOP: John Davies, winner of the Future Designer Award, with James Alexander-Sinclair and Mark Godden of Deepdale Trees Ltd **ABOVE:** Theatrical lighting in one of the collection of six winning designs



ABOVE: Charlotte's multi-award-winning garden

RIGHT: Charlotte Rowe MSGD, winner of the Lighting Award

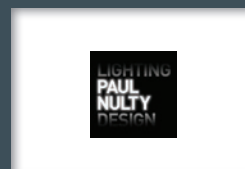

SPONSOR: Paul Nulty Lighting Design

WINNER: Charlotte Rowe MSGD

GARDEN LIGHTING AWARD

Awarded for the design and implementation of a lighting scheme for an outdoor space. Open to FSGD and MSGD

PROJECT: Wimbledon Garden

LOCATION: London

About the garden:

Winner of the Medium Residential Garden Award (see also page 21) and Hard Landscaping Award (see page 23).

The designer's role:

Architectural elements of the façade and climbers, trees and selected shrubs are uplit, while LEDs are set under water to throw light along the water feature and to uplight the vertical element. Narrow beam LEDs uplight the fireplace, which is also downlit to wash the fireplace wall with light. Linear LEDs uplight a bench to give a floating effect, and asymmetrical LEDs are set on the side of steps to graze the treads with light.

The judges said:

- "Good, subtle design."
- "A worthy winner."





SPONSOR: Barcham Trees Ltd
WINNER: Sue Townsend MSGD

PLANTING DESIGN AWARD

Awarded to a planting scheme for public or private use that conveys innovative, creative, functional, aesthetic and environmental design solutions. Open to FSGD, MSGD and Pre-registered members

PROJECT: *Suffolk Manor Garden*
LOCATION: *Suffolk*

About the garden:

This garden is on heavy clay soil and is exposed to the wind. A greater link was needed between the house and surrounding landscape and a swimming pool area needed to be partially enclosed with planting to the south, east and west.

The designer's role:

To create a contemporary courtyard garden, an Arts and Crafts-inspired pergola and planting with a bridge across a moat to a pinetum; prairie-style planting to the rear, a scented winter garden and hot border enclosing the front lawn.

The judges said:

- "Structure and spatial composition focused around planting."
- "The designer displays complete control of spatial design through the use of texture, colour and form of plants."
- "The character of spaces range from classical simplicity at the entrance, intense intimacy of a courtyard, terrace, orchard, through structured woodland, moat and meadow back to the wild formality of an Arts and Craft pergola."
- "It is rich with variety."



BELOW AND LEFT:
Judges said the garden was "rich with variety"



LEFT: Sue Townsend MSGD with David Johnson of Barcham Trees Ltd





SPONSOR: Harrod Horticultural
WINNER: Dan Pearson MSGD

HISTORIC GARDEN RESTORATION AWARD

Awarded to a design demonstrating the skills required to restore or renovate an historic garden for private or public use. Open to FSGD, MSGD and Pre-registered members

PROJECT: Folly Farm
LOCATION: Berkshire

About the garden:

A Grade 1 listed Arts and Crafts garden designed by Sir Edwin Lutyens and Gertrude Jekyll, created between 1906 and 1912.

The designer's role:

A site-wide masterplan, landscape and garden designs were commissioned and a complete dilapidations programme was also required for restoration and/or refurbishment of historic hard landscaping, along with new hard landscaping designed with reference to Lutyens vernacular. New planting was designed 'in the spirit of' Jekyll. In addition to new planting schemes for the historic gardens, new additions include the approach and entrance drive, a plan for the one-acre walled garden, a Wind Garden, wildlife lake, watercourse and crossings, sculpture lawn and the establishment of wildflower meadows, hedgerows and shelter-belt tree planting. In-depth historical research was carried out using the extensive archive of the current owners, augmented by the extensive material available on both Lutyens' and Jekyll's architectural and garden designs.

The judges said:

- "The lack of evidence for certain areas of the garden has become a positive factor in the hands of Dan Pearson."
- "His new plan is composed of plants that were known to be favourites of Jekyll, using her written work and more detailed extant archival planting plans for other properties from the same period."
- "He has created new schemes with her planting style and colour palette and the result is a sensitive, beautiful and intelligent response to the brief."



ABOVE AND RIGHT: The entire site of Folly Farm was restored in the spirit of Lutyens and Jekyll



All photos: Jason Ingram



LEFT: Dan Pearson MSGD, winner of the Historic Garden Restoration Award, with Stephanie Harrod of Harrod Horticultural
BELOW: Historical evidence was referenced where possible

SGD
2014
AWARDS



SPONSOR: Alitex
WINNER: Beth Chatto

THE JOHN BROOKES LIFETIME ACHIEVEMENT AWARD

Awarded to an individual who has made an outstanding contribution to the profession, and gifted by the SGD Council

- See our interview with Beth Chatto on page 34

Philippa O'Brien MSGD, Chair of the SGD, said:

- "Beth Chatto was a natural choice for the John Brookes Lifetime Achievement Award. She has influenced countless generations of gardeners and garden designers through her passion for plants, her ecological approach and her inspired garden writing, continuing the important cycle of sharing and learning about plants. To a whole generation of garden designers she is considered the guru of shade planting."



ABOVE: John Brookes MBE FSGD with Julia Boulton, Beth Chatto's granddaughter, and John Lawson of Alitex

SGD
2014
AWARDS



ABOVE: Judges called the garden "full of life and hope"



SPONSOR: Homes & Gardens
WINNER: Cleve West MSGD

PEOPLE'S CHOICE AWARD

Chosen by public vote from finalists in International, Public or Communal Outdoor Space and Large, Medium and Small Residential, and Pocket Garden categories. The award is chosen by public vote on the *Homes & Gardens* magazine's website

PROJECT: Horatio's Garden (winner of the Public or Commercial Outdoor Space Award, see page 20)



RIGHT: Cleve West MSGD, winner of the People's Choice Award, with Arabella St John Parker, *Homes & Gardens* magazine



SPONSOR: David Harber Ltd

WINNER: Cleve West MSGD

THE JUDGES' CHOICE AWARD

Chosen from finalists in International, Public or Communal Outdoor Space, and Large, Medium and Small Residential, and Pocket Garden categories

PROJECT: *Horatio's Garden* (winner of the Public or Commercial Outdoor Space Award, page 20, and the People's Choice Award, page 31)

The judges said:

- "This is what healing gardens should be like; if only they all had a similar design."
- "It has beautiful planting that works with the scale of the building and helps to reconnect people to nature."



ABOVE: Low limestone walls weave through the garden simulating the form of a spine

RIGHT: Cleve West MSGD, winner of The Judges' Award, with Richard Sneesby and David Harber



ABOVE: The refurbished lake, complete with new boathouse



SPONSOR: Europlants UK Limited

WINNER: Ian Smith MSGD

THE SGD GRAND AWARD WINNER

Selected from winners of the International, Public or Communal Outdoor Space, and Large, Medium and Small Residential, and Pocket Garden categories – the winner of winners

PROJECT: *Millwater* (winner of the Large Residential Garden Award, see page 22)

The judges said:

- "This scheme achieves one of the most difficult goals in garden design: it really feels as if it has been in situ for several decades."
- "This is a transformational project. Devised as a journey through spaces, it feels composed and perfectly linked."
- "The garden has a period ambience, exhibiting confidence of scale."
- "It is a well executed, integrated design with sharp edges softened by sophisticated planting."



LEFT: Ian Smith MSGD, winner of The Grand Award with Brigitte Canale, Europlants